

NO.	DESCRIPTION	DATE	BY

TRIBUNAL GENERAL DE JUSTICIA  
 OFICINA DE ADMINISTRACION DE LOS TRIBUNALES  
 DIRECTORIA DE ADMINISTRACION  
 OFICINA DE ADMINISTRACION Y CONSERVACION DE LOCALES  
 APPROVED BY: \_\_\_\_\_ APPROVED DATE: \_\_\_\_\_

PROJECT NAME: SALA ESPECIALIZADA DE VIOLENCIA DE GENERO  
 PROJECT LOCATION: AGUADILLA PUERTO RICO  
 DRAWING DESCRIPTIONS: PLANTA DE PISO A EXISTENTE  
 GERENTE DE PROYECTO: ING. DANIEL PADILLA  
 CHECKED BY: ING. DANIEL PADILLA  
 DRAWN BY: DANIEL PADILLA  
 SHEET NO.: A-03  
 PRINTING DATE: SEPTIEMBRE 2025  
 DRAWING SCALE: 3/8"=1'-0"

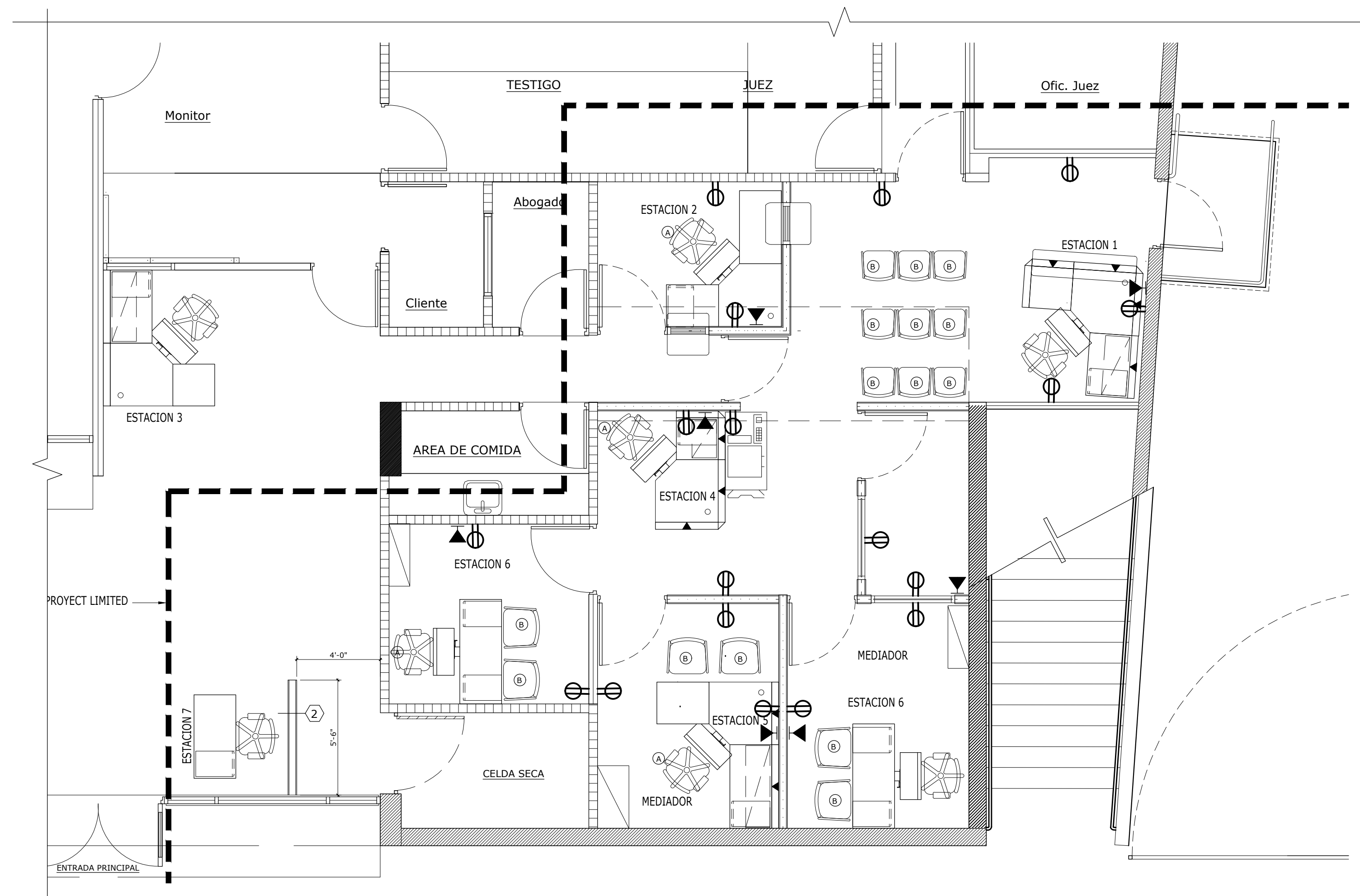

**MODULACION FLOOR PLAN (SALA ESPECIALIZADA DE VIOLENCIA DE GENERO)**  
 SCALE: 1/4" = 1'-0"

**ESTACION 1 CANTIDAD 1**

MKD	Quantity	Product Description
A	1	Dial-a-Tilt Short Track Keyboard Arm, Teflon Slide, Base Swivel,+10°/-15° (25"W x 10.5"D)
B	1	90° Corner Worksurface, 48"w x 24"d
C	1	Rectangular Worksurface With End Panel, 24"d x 24"w
D	1	Rectangular Countertop, 15"d x 60"w, Center to the panel.
E	1	Overhead Cabinet, Panel-mounted, 15"h x 42"w x 15-1/2"d (min.)
F	1	Pedestal, 22"d, Box, Box, File
G	1	Rectangular Worksurface With End Panel, 24"d x 36"w

**ESTACION 2 CANTIDAD 1**

MKD	Quantity	Product Description
A	1	Dial-a-Tilt Short Track Keyboard Arm, Teflon Slide, Base Swivel,+10°/-15° (25"W x 10.5"D)
B	1	90° Corner Worksurface, 36"w x 24"d
C	1	Rectangular Worksurface With End Panel, 24"d x 42"w
D	1	Rectangular Worksurface With End Panel, 24"d x 30w
E	1	Pedestal, 22"d, Box, Box, File

**ESTACION 3 CANTIDAD 1**

MKD	Quantity	Product Description
A	1	Dial-a-Tilt Short Track Keyboard Arm, Teflon Slide, Base Swivel,+10°/-15° (25"W x 10.5"D)
B	1	90° Corner Worksurface, 30"w x 24"d
C	1	Rectangular Worksurface With End Panel, 24"d x 24"w
D	1	Rectangular Worksurface With End Panel, 24"d x 42w
E	1	Overhead Cabinet, Panel-mounted, 15"h x 42"w x 15-1/2"d (min.)
F	1	Pedestal, 22"d, Box, Box, File

**ESTACION 7 CANTIDAD 1**

MKD	Quantity	Product Description
A	1	Rectangular Worksurface With End Panel, 24"d x 48"w
B	1	Pedestal, 22"d, Box, Box, File

**ESTACION 4 CANTIDAD 1**

MKD	Quantity	Product Description
A	1	Dial-a-Tilt Short Track Keyboard Arm, Teflon Slide, Base Swivel,+10°/-15° (25"W x 10.5"D)
B	1	90° Corner Worksurface, 36"w x 24"d
C	1	Rectangular Worksurface With End Panel, 24"d x 24"w
D	1	Overhead Cabinet, Panel-mounted, 15"h x 24"w x 15-1/2"d (min.)
E	1	Pedestal, 22"d, Box, Box, File

**ESTACION 5 CANTIDAD 1**

MKD	Quantity	Product Description
A	1	Dial-a-Tilt Short Track Keyboard Arm, Teflon Slide, Base Swivel,+10°/-15° (25"W x 10.5"D)
B	1	90° Corner Worksurface, 36"w x 24"d
C	1	Rectangular Worksurface With End Panel, 30"d x 24"w
D	1	Rectangular Worksurface With End Panel, 48"d x 24"w
E	1	Overhead Cabinet, Panel-mounted, 15"h x 48"w x 15-1/2"d (min.)
F	1	Pedestal, 22"d, Box, Box, File

**ESTACION 6 CANTIDAD 2**

MKD	Quantity	Product Description
A	1	Dial-a-Tilt Short Track Keyboard Arm, Teflon Slide, Base Swivel,+10°/-15° (25"W x 10.5"D)
B	2	Pedestal, 22"d, File, File
C	1	Rectangular Work surface With End Panel, 24"d x 60"w

**SILLA TIPO A CANTIDAD 8**

**Product Description**  
Silla ejecutiva acojinada con ruedas.

**SILLA TIPO B CANTIDAD 15**

**Product Description**  
Silla plastica color negro, sin ruedas.